

WiZARD Mask Guide

Mask Assembling Guide

WiZARD 510





Mask Assembling Guide

WiZARD 320

Mask Assembling Guide

WiZARD 310

WiZARD 510 Nasal Mask Assembling Guide

   	Component	Reference Number
1	1 WiZARD 510 Nasal Mask Cushion, Large	SM00050
2	2 WiZARD 510 Nasal Mask Cushion, Small/Medium	SM00051
3	3 WiZARD 510 Headgear with Buckles	SM00052
4	4 WiZARD 510 Frame with short tube	SM00053

Caution! Please confirm that all the components belong to WiZARD 510 Nasal Mask by checking the reference number before assembling.



1 Attach the cushion (SM00050-51) to the mask frame (SM00053) by aligning the arrow ▲ on the cushion to "WiZARD 510" on the frame. (Shape of the frame has been designed to the cushion in one way only)



2 Lay flat the headgear (SM00052) with the WiZARD logo downward



3 Keep "Wizard 510" on the frame (SM00053) upward. Hook the headgear (SM00052) clips on the mask frame



4 Assembly completed. (The WiZARD logo should be outward on the back of headgear)

Note: For complete user instructions, refer to the WiZARD 510 User manual.



WiZARD 320 Full Face Mask Assembling Guide

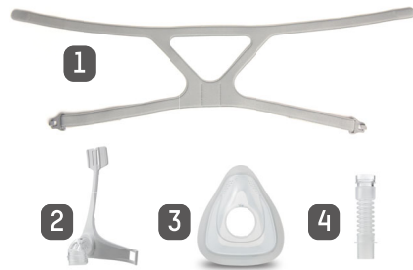

Component	Reference number
1 WiZARD 310/320 Headgear with Buckles	SM00043
2 WiZARD 320 Elbow Connector with frame	SM00040
3 WiZARD 320 Full Face Mask Cushion, Large	SM00047
3 WiZARD 320 Full Face Mask Cushion, Medium	SM00048
3 WiZARD 320 Full Face Mask Cushion, Small	SM00049
4 Small Silicon Tubing	SM00016

Caution! Please confirm that all the components belong to WiZARD 320 Full Face Mask by checking the reference number before assembling.



1 Connect the silicon tube (SM00016) to the frame (SM00040) directly



2 Align the arrow on cushion (SM00047-49) to the groove on frame (SM00040) and assemble them together directly



3 Lay flat the headgear (SM00043) with WiZARD label downwards



4 Place the frame on the center of headgear (SM00043) and hook on the buckles

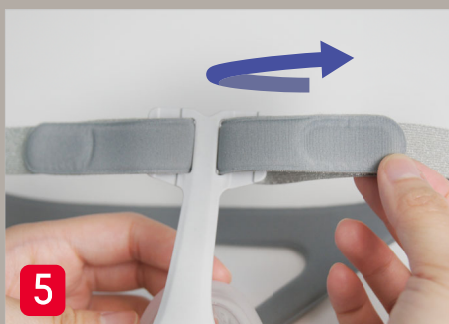

5 Assemble the upper straps through the holes in front of forehead pad and attach the velcros



6 Assembly completed. (The WiZARD logo should be outwards on the back of headgear)



WiZARD 310 Nasal Mask Assembling Guide

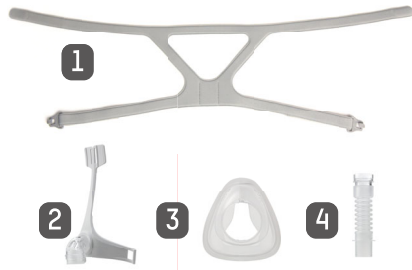

Component	Reference number
1 WiZARD 310/320 Headgear with Buckles	SM00043
2 WiZARD 310 Elbow Connector with frame	SM00041
3 WiZARD 310 Nasal Mask Cushion, Large	SM00044
3 WiZARD 310 Nasal Mask Cushion, Medium	SM00045
3 WiZARD 310 Nasal Mask Cushion, Small	SM00046
4 Small Silicon Tubing	SM00016

Caution! Please confirm that all the components belong to WiZARD 310 Nasal Mask by checking the reference number before assembling.



1 Connect the silicon tube (SM00016) to the frame (SM00041) directly



2 Align the arrow on cushion (SM00044~46) to the groove on frame (SM00041) and assemble them together directly



3 Lay flat the headgear (SM00043) with WiZARD label downwards



4 Place the frame on the center of headgear (SM00043) and hook on the buckles

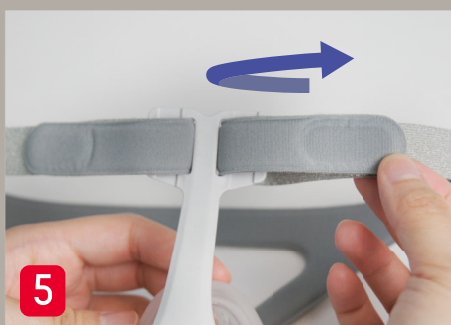

5 Assemble the upper straps through the holes in front of forehead pad and attach the velcros



6 Assembly completed. (The WiZARD logo should be outwards on the back of headgear)

